

LEJEUNE COMPLETES FIRST PHASE OF THE KISHWAUKEE CANCER CENTER

LEJEUNE
STEEL COMPANY
a subsidiary of API Group, Inc.

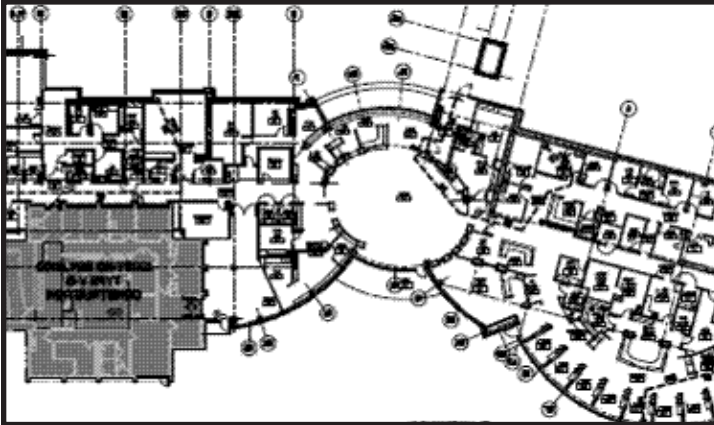

Dec. 28, 2009 — **LEJEUNE** delivers the anchor bolts for the Kishwaukee Community Hospital's new Cancer Care Center. The completion of this first phase allows LeJeune to prepare for the 21,000 square-foot addition.

The project is fast pace to meet its 2010 grand opening. It is located across from the Kishwaukee Hospital in Dekalb, Ill., which LeJeune also provided the structural steel.

LeJeune will provide more than 180 tons of structural steel and 15 tons of bar joist. The cancer center will feature a major front entrance canopy, with 20 feet of cantilevers. The galvanized and painted screen wall will frame with HSS sections. Radius shaped walls will require rolled HSS framing at the perimeter to support a glass façade.

Wisconsin Structural Steel Co., a sister company of LeJeune, will complete the fabrication and will deliver the steel in March 2010. ♻️



*USGBC and related logo is a trademark owned by the U.S. Green Building Council and is used by permission.